

## 9 Slatin Road, Strood, Rochester, Kent, ME2 3AU

Draft details. WOW WOW WOW. A truly stunning property within walking distance to the train station and local High Street. This really is move in ready with the house being transformed by the current seller into a luxury home. Ideal for first time buyers or home-movers alike wanting to upgrade. Accommodation comprises of an entrance hall with varnished floorboards, neutrally decorated lounge and with the refurbished kitchen/diner to the rear that boasts integral oven, hob, washer/dryer and dishwasher. There are French doors to the rear garden, which is larger than normal for this road. On the first floor you have the landing with loft access, 2 bedrooms and a stunning refurbished bathroom with roll-top bath. As standard the property comes with double glazed windows, gas central heating and also benefits from a front garden. Call us today to book your internal viewing.

- 2 BEDROOMS
- STUNNING UPSTAIRS BATHROOM
- MODERN REFURBISHED KITCHEN/DINER
- IDEAL FIRST HOME
- MOVE IN READY
- GOOD SIZE REAR GARDEN
- CENTRAL LOCATION
- WALKING DISTANCE TO STATION
- VIEWING ESSENTIAL

**£220,000**

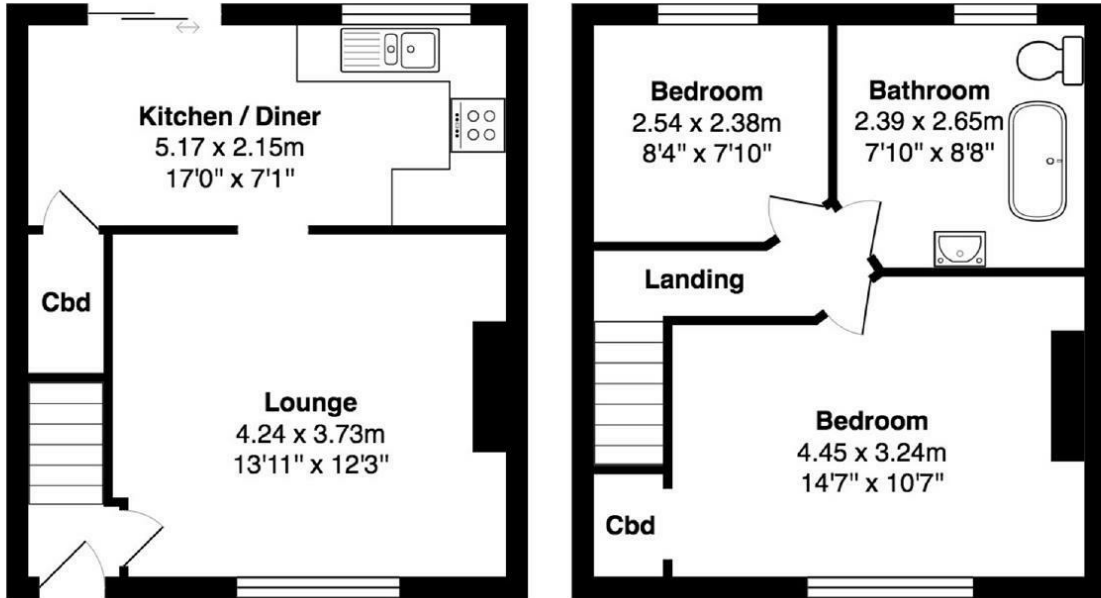

Total Area: 62.3 m<sup>2</sup> ... 670 ft<sup>2</sup>

All measurements are approximate and for display purposes only.

